

Kronos

Peristaltic dosing pump



The **Kronos**

PERISTALTIC METERING PUMP DRIVE BY A STEPPER MOTOR

The feed chemical is conveyed by means of the rotor squeezing on the hose. No valves are needed for this. This ensures gentle handling of the metered media.

The housing is made from shock-proof and chemical resistant PPE with IP65 protection degree. It is equipped with several inputs for metering configuration.

The stepper motor means that metering is infinitely adjustable.

Typical applications are in processes where only a low discharge pressure is required, such as in the metering of chemicals into galvanic baths, in clarification tanks or for metering conditioning agents into swimming pools (flocculants, activated carbon and chemicals).



Features

■ DOSING

- By stepper motor technology
- Safely **up to 10 l/h** and **up to 3 bar**
- Suitable firmware micro dosing
- Minimum dosing note 2 ml/h continuous

■ MOTORS

- Accurate, reliable and ultra quiet <35 db
- Direct coupling

■ TUBING

The perfect choice to dose degassing liquid without the needs of "special" accessories

■ MODE

● FULL MODE

kronos FM pump has multi-function setting there are six (6) different configuration, as following:

- Manual Mode (Constant dosing)
- mA Mode (Proportional dosing)
- PPM Mode (Concentration dosing)
- 1:N Mode (Speed up dosing)
- N:1 Mode (Speed down dosing)
- Batch Mode (Setting dosing)

● CONDUCTIVITY MODE

kronos CR pump has a conductivity measure integrated. The dosing pump has two (2) different configuration, as following:

- Manual Mode (Constant dosing)
- Conductivity Mode (SetPoint Dosing)

Products Line

Model	Nominal Pressure	Delivery Rate	Minimum Delivery Rate	Tubing	Tubing internal diameter
kronos50 FM10	2 bar	10 l/h	10 ml/h	seko Med	6 mm
kronos50 FM02	3 bar	2 l/h	2 ml/h	seko Extra	3 mm
kronos50 CR10	2 bar	10 l/h	10 ml/h	seko Med	6 mm

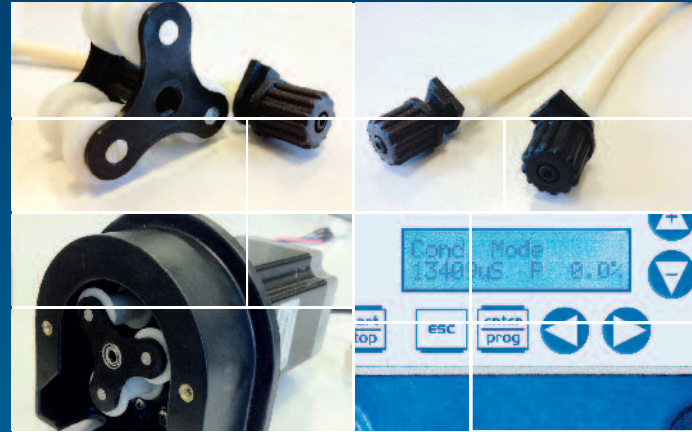

Design and Functional description

The device is housed in a robust plastic housing.

The plastic housing is comprised of upper and lower sections, which are screwed together. The lower section contains the PCBs for power supply and connectors.

This construction technology simplify the installation: block part will easily fixed at the wall and all wire are connected on that part.

Once wiring is completed the front part can do screwed on the block one.

The liquid end is mounted at the front and is closed off by means of a screwed transparent cover to protect against injuries. The pump hose can easily be exchanged after the transparent cover has been removed.

The rotary movement of the rotors alternately press and relax pump hose by three rollers. As a result, the liquid is sucked in and transported through the pressure hose without stress. The pump si self priming in all conditions.

Dimensions

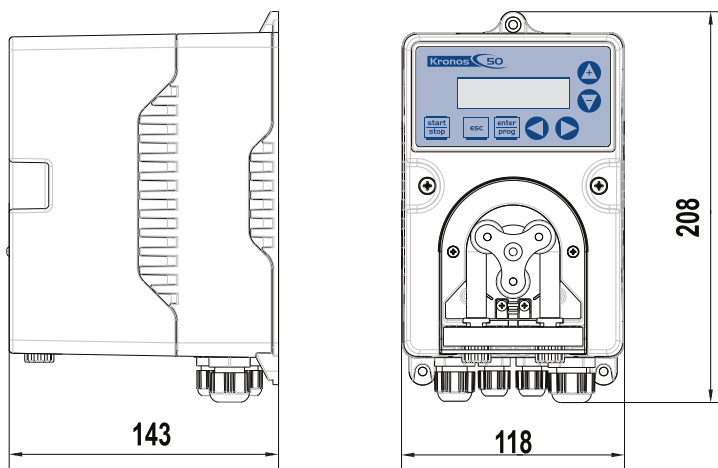

Ordering information

Code	Model	Description
KRFM0210	kronos50 FM10	kronos 10 l/h @2 bar full mode
KRFM0302	kronos50 FM02	kronos 2 l/h @3 bar full mode
KRCR0210	kronos50 CR10	kronos 10 l/h @2 bar conductivity mode

A Worldwide Group at your service

seko has been a significant manufacturer of metering pumps and dosing systems for over 40 years. This long activity allowed **seko** to acquire a vast experience in diversified applications and to confirm its international success in many industrial fields through the supply of reliable solutions for the dosing, injection and transfer of liquids

Today **seko** is an International Group, developing, manufacturing and delivering its products in more than 50 countries, through its 16 subsidiaries and an extended network of distributors, agents and authorized dealers



BRAZIL

■ Seko do Brasil Comercio de Sistemas de Dosagem Limitada

03170-050 São Paulo (SP)
Phone: +55 11 2606 9878
Fax: +55 11 2606 9878
sekobrasil@sekobrasil.com.br
www.sekobrasil.com.br

CHINA

■ Seko China Ltd

072750 Hebei
Phone: +86 312 552 0904
Fax: +86 312 552 0901
china@seko.com
www.sekochina.com

DENMARK

■ Seko Denmark

DK-4930 Maribo
Phone: +45 5475 7545
Fax: +45 5474 7545
info@seko.com

FRANCE

■ Seko Lefranc-Bosi S.A.

77435 - Marne La Vallée Cedex 2
Phone: +33 1 6005 9060
Fax: +33 1 6480 4104
lefrancbosi@lefrancbosi.com
service.commercial@seko.fr
www.lefrancbosi.com

GERMANY

■ Seko Deutschland GmbH

55252 Mainz - Kastel
Phone: +49 6134 2858 10
Fax: +49 6134 2858 29
info@seko-messtechnik.de
www.seko-germany.com

ITALY

■ Seko Spa

Via Salaria Km. 92,200
02010 S.Rufina - Rieti
Phone: +39 0746 605801
Fax: +39 0746 607072
sales@seko.com

ITALY

■ Seko Spa [Process & Sytems]

Via Di Vittorio, 25
20068 Peschiera Borromeo - Milano
Phone: +39 02 97372411
Fax: +39 02 55301744
info.psd@seko.com
info@seko.com

ROMANIA

■ Seko Sieta S.r.l.

400393 Cluj-Napoca
Phone: +40 264 415 251
Fax: +40 264 415 622
info.dpro@seko.com

RUSSIA

■ OOO Seko

129347 - Moscow
Phone: +74 99 182 52 36
Fax: +74 99 182 52 36
sekorussia@seko.com
www.sekorussia.ru

SINGAPORE

■ Seko Dosing Systems Asia Pacific Pte Ltd

608838 Singapore
Phone: +65 6515 6996
Fax: +65 6515 5079
asiapacific@seko.com

SOUTH AFRICA

■ Seko Southern Africa (PTY) Ltd

Kyasand - Johannesburg - Gauteng
Phone: +27 11 704 6589
Fax: +27 11 704 6588
sales@sekosa.co.za

SPAIN

■ Seko Ibérica Sistemas de Dosificación S.A.

08960 Sant Just Desvern - Barcelona
Phone: +34 93 4802 570
Fax: +34 93 4802 571
sekoiberica@sekoiberica.com

SWEDEN

■ Seko Sweden

26123 Landskrona
Phone: +46 418 448 482
Fax: +46 418 448 483
info@seko.com

TURKEY

■ Seko Endüstriyel Pompalar ve Proses Sistemleri San. ve Tic. Ltd. Şti.

Kartal Istanbul
Phone: +90 216 353 2542
Fax: +90 216 353 1450
info@seko.com.tr
www.seko.com.tr

UNITED ARAB EMIRATES

■ Seko Middle East FZE

P.O. Box 42090 - Hamriyah Free Zone, Sharjah
Phone: +971 65264982
Fax: +971 65264983
info@sekome.ae
sales@sekome.ae

UNITED KINGDOM

■ Seko UK

Chemical Controls Ltd
Harlow, Essex - CM19 5JH
Phone: +44 1279 423550
Fax: +44 1279 423993
seko.uk@seko.com
www.sekouk.com

USA

■ Seko Dosing Systems Corporation

Tullytown - PA 19007
Phone: +1 215 945 01 25
Fax: +1 215 945 09 37
sales@sekousa.com
www.sekousa.com

For more information
www.seko.com

